

# Rotation Probe D-T-TSR.C Series

## Description

This probe is designed for inspection of boreholes and tube end sections and use in the probe rotor SRT-1500. The probe is operated in differential mode for detection of local defects.

## Technical Data

Freq. Range	: 30 kHz - 200 kHz 200 kHz - 500 kHz
Coil Assem.	: Send-receive mode (differential)
Coil Element	: 5x4 mm
Diameter	: 14 mm - 50 mm (bigger diameter upon customer request)
Probe Length	: 30 - 150 mm (Other lengths upon customer request)
Connector	: Fischer Series 102 / 4 pins (different connector upon customer request)
Shaft	: diameter 8 <sup>H7</sup> mm
Probe body	: delrine or austenite

## Accessories

\* probe certificate

## Order Information

\* Necessary specifications:

- frequency range
- probe diameter in mm
- connector type
- probe body material



# Rotation Probe D-T-TSR.F Series

## Description

This probe is designed for inspection of boreholes and tubes and use in the probe rotor RB-18. The probe can be ordered as differential, multi-differential or absolute probe.

## Technical Data

Freq. Range	: 30 kHz - 200 kHz 200 kHz - 500 kHz
Coil Assem.	: Send-receive mode (differential) Send-receive mode (multi-differential) Send-receive mode (absolute)
Coil Element	: diameter 4.5 mm or 1.5mm
Diameter	: 18 mm - 50 mm (bigger diameter upon customer request)
Connector	: Fischer Series 102 / 4 pins (different connector upon customer request)
Shaft	: diameter 8 <sup>H7</sup> mm
Probe body	: delrine or austenite

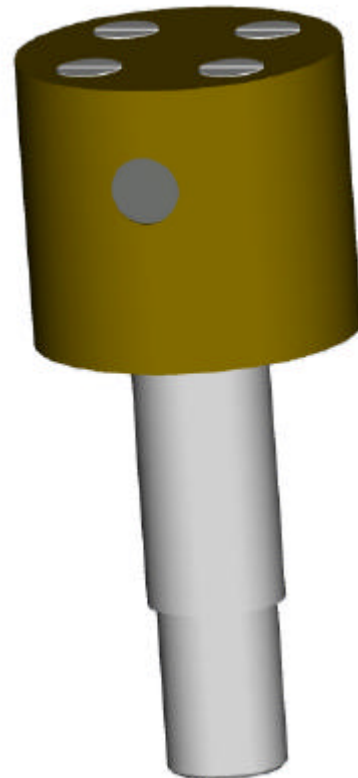

## Accessories

\* probe certificate

## Order Information

\* Necessary specifications:

- frequency range
- probe diameter in mm
- connector type
- probe body material

# Rotation Probe D-T-TSR.SM Series

## Description

This probe is designed for inspection of the cone area at boreholes. The sensor in the probe is sensitive over the total cone section. The probe is operated in differential mode for detection of local defects. It can either be delivered with front ball bearing for centering in the borehole or without. The rotating probe can be used in the probe rotor SRT-1500.

## Technical Data

Freq. Range	: 200 kHz - 500 kHz
Coil Assem.	: Send-receive mode (differential)
Coil Element	: upon specification
Diameter	: 4 mm - 50 mm without ball bearing 8 mm - 50 mm with ball bearing (bigger diameter upon customer request)
Probe Length	: 30 - 100 mm (other lengths upon customer request)
Connector	: Fischer Series 102 / 4 pins (different connector upon customer request)
Shaft	: diameter 8 <sup>H7</sup> mm
Probe body	: delrine or austenite

## Accessories

\* probe certificate

## Order Information

\* Necessary specifications:

- frequency range
- max. and min. diameter of the cone
- angle of the cone
- with or without ball bearing
- connector type
- probe body material



# Rotation Probe D-T-TSR.PP Series

## Description

This probe is a standard probe designed for the inspection of boreholes. The probe is operated in differential mode for detection of local defects. The rotating probe can be used in the probe rotor SRT-1500.

## Technical Data

Freq. Range	: 200 kHz - 500 kHz
Coil Assem.	: Send-receive mode (differential)
Coil Element	: upon specification
Diameter	: 3 mm - 20 mm (bigger diameter upon customer request)
Probe Length	: 30 - 100 mm (other lengths upon customer request)
Connector	: Fischer Series 102 / 4 pins (different connector upon customer request)
Shaft	: diameter 8 <sup>H7</sup> mm
Probe body	: austenite

## Accessories

\* probe certificate

## Order Information

\* Necessary specifications:

- frequency range
- connector type



# Rotation Probe D-T-TSR.B Series

## Description

This probe is a standard probe designed for the inspection of boreholes. The probe is operated in differential mode for detection of local defects. By the elliptical form of the probe end the friction in the borehole is minimized and a stop or interruption of the rotation is prevented. The rotating probe can be used in the probe rotor SRT-1500.

## Technical Data

Freq. Range	: 200 kHz - 500 kHz
Coil Assem.	: Send-receive mode (differential)
Coil Element	: upon specification
Diameter	: 4 mm - 20 mm (bigger diameter upon customer request)
Probe Length	: 30 - 100 mm (other lengths upon customer request)
Connector	: Fischer Series 102 / 4 pins (different connector upon customer request)
Shaft	: diameter 8 <sup>H7</sup> mm
Probe body	: austenite

## Accessories

\* probe certificate

## Order Information

\* Necessary specifications:

- frequency range
- connector type



# Rotation Probe D-T-TSR.SP Series

## Description

This probe is a standard probe designed for the inspection of boreholes. The probe is operated in differential mode for detection of local defects. By its spreadable probe shaft the probe compensates variations in the borehole diameter of approx. +/- 0.5mm. The rotating probe can be used in the probe rotor SRT-1500.

## Technical Data

Freq. Range : 200 kHz - 500 kHz  
Coil Assem. : Send-receive mode (differential)  
Coil Element : upon specification  
Diameter : 8 mm - 30 mm  
(bigger diameter upon customer request)  
Probe Length : 30 - 100 mm  
(other lengths upon customer request)  
Connector : Fischer Series 102 / 4 pins  
(different connector upon customer request)  
Shaft : diameter 8<sup>H7</sup> mm  
Probe body : austenite

## Accessories

\* probe certificate

## Order Information

\* Necessary specifications:

- frequency range
- connector type

